

Radio  
Receivers

Remotes

Gate  
Controllers

Gate  
Automation  
Accessories

Gate  
Motors

Access  
Control



INTENSITY  
24V  
SPEED

MAGNETIC  
LIMIT  
SWITCHES

# SWIFT 624



- built-in encoder
- gate weight up to 600kg
- aluminium body
- program change of motor working direction

SWIFT624 electromechanical drive is designed for sliding gates used by individual customers. Solutions used in the motors provide the reliability, comfort and safety.

# SWIFT 624

sliding gate electromechanical drive

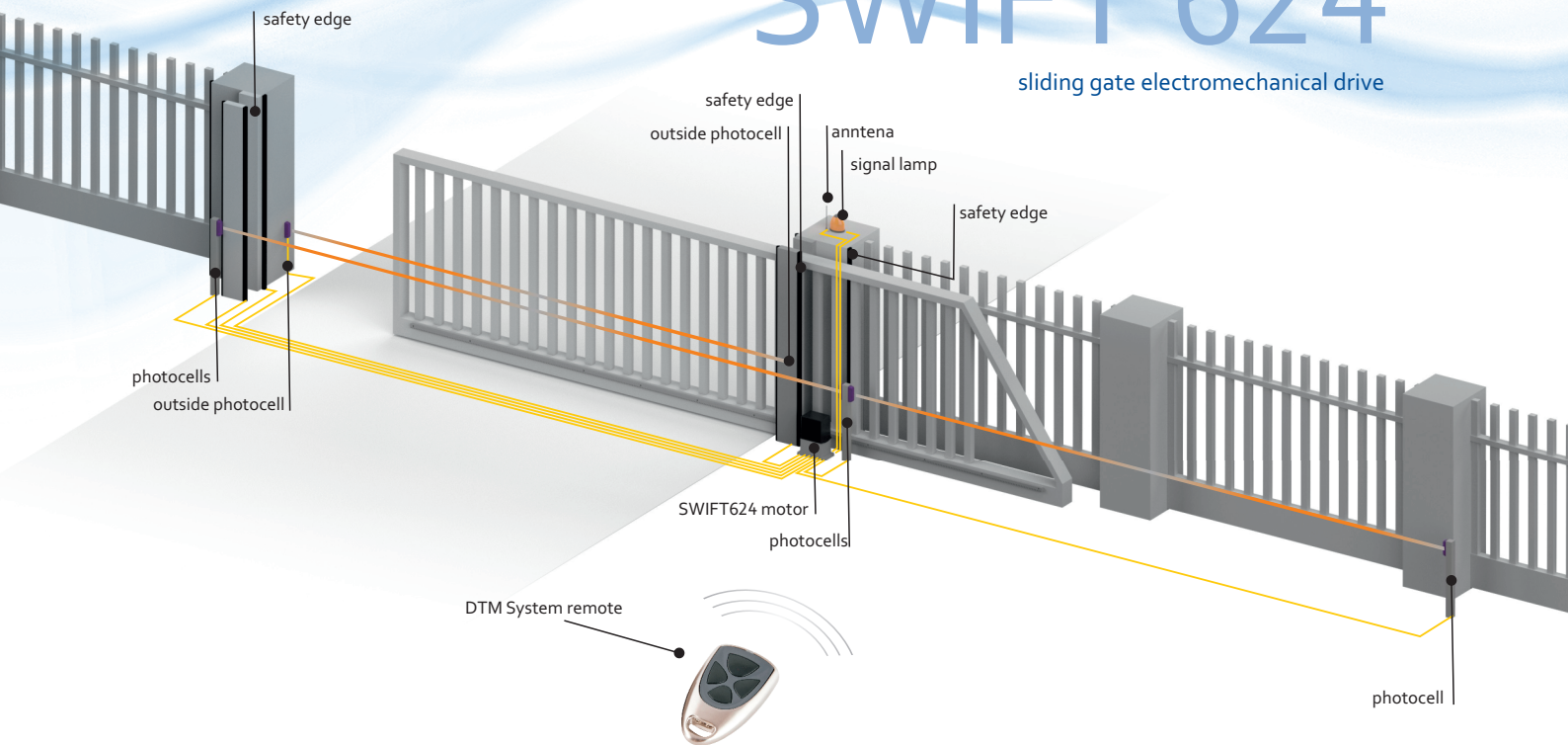

## Motor dimensions

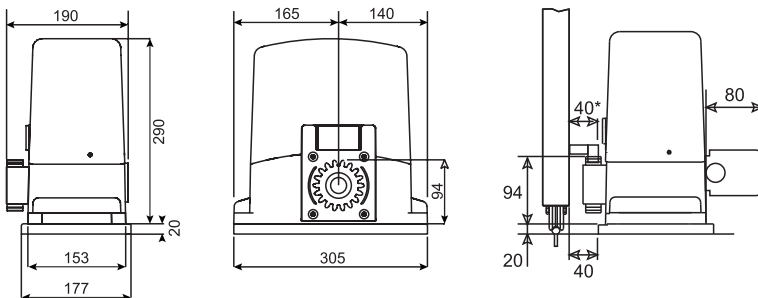

## Safety and reliability

24V DC supplied SWIFT624 motor is a simple way to automate sliding gates of weight up to 600kg, used by private customers and small businesses. Equipped with encoder monitoring movement allows the gate controller to react quickly to obstacles appearance.

## Fast and intensive work

SWIFT624 is a durable motor for intensive work. It can operate up to 30 cycles of opening and closing the gate per hour. 24V DC power supply increases safety and magnetic limit switches allow precise designation of the final positions of the gate.

## Synchronization of two gates

Gate controller function "master-slave" allows to operate two gates sliding in opposite direction, operating in synchrony.

## Technical data

case material:	aluminium with plastics elements
motor power supply	24V DC
gate controller power supply:	230VAC / 50Hz $\pm$ 10%
electricity consumption:	8A
power consumption:	250W
encoder:	built-in
limit switches:	magnetic
protection class:	IP-44
thermal protection:	none
leaf motion speed:	10-16m / min
drawbar pull:	600N
motor rotation speed:	1400rpm
operation intensity:	50%/h (30 cycles/h)
temperature range (min./max.):	-25°C / +55°C
motor weight:	10kg

## Gate parameters

weight: up to 600kg

